



ASPIRE

— TO MOVE —



Newbridge Road, Bath, BA1

Video and physical viewings available. Studio flat offered furnished or unfurnished on Newbridge Road, Bath. Available now.

Newbridge occupies an area to the west of Bath city centre, just north of the River Avon. The main shopping area in Newbridge is Chelsea Road, a small area of shops, restaurants and hairdressers. Shops include a bakery, a hardware shop, a SPAR supermarket, a cycle shop and nearby on Newbridge Road a post office. Bus stops can be found at regular intervals along both Newbridge Road and Newbridge Hill which provide access to Bath city centre and both universities. Bath spa train station is 1.7 miles from Chelsea Road. The area benefits from its close proximity to the Royal United Hospital.

- Studio flat
- Available now
- Furnished
- Video viewing available
- Newbridge Road
- Holding deposit: £213
- Council tax band A
- Deposit: £1096

£895 PCM

Floor Plans

GROUND FLOOR
292 sq.ft. (27.1 sq.m.) approx.

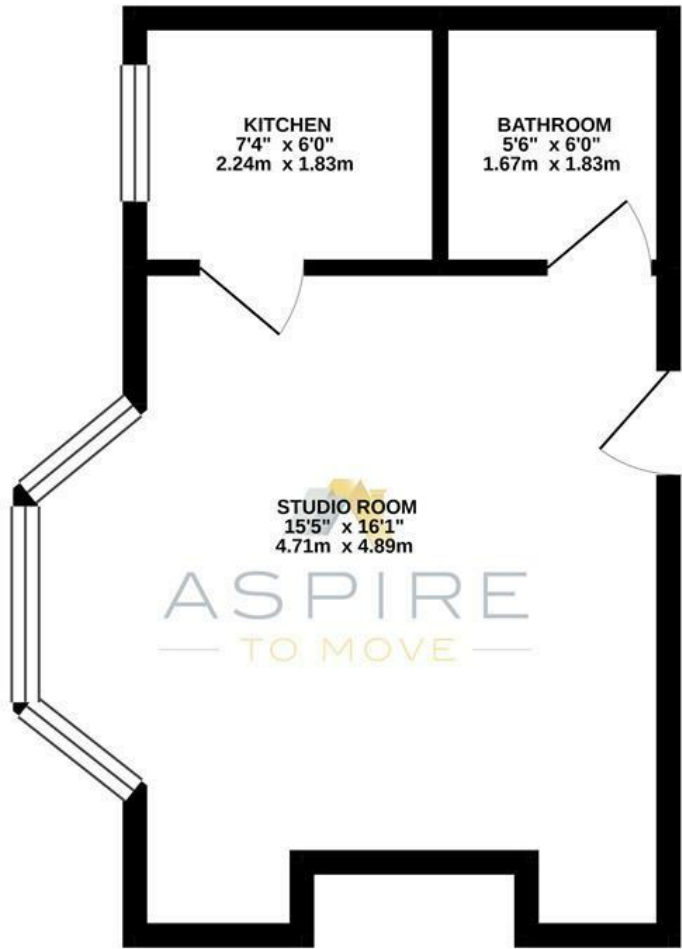

NEWBRIDGE ROAD, BATH, BA1

TOTAL FLOOR AREA: 292 sq.ft. (27.1 sq.m.) approx.

Whilst every attempt has been made to ensure the accuracy of the floorplan contained here, measurements of doors, windows, rooms and any other items are approximate and no responsibility is taken for any error, omission or mis-statement. This plan is for illustrative purposes only and should be used as such by any prospective purchaser. The services, systems and appliances shown have not been tested and no guarantee as to their operability or efficiency can be given.
Made with Metropix ©2021

Energy Performance Graph

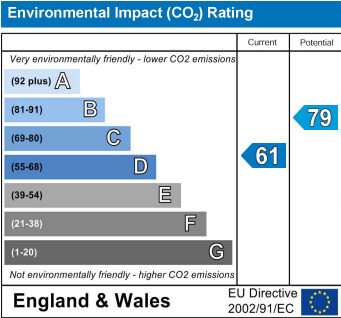
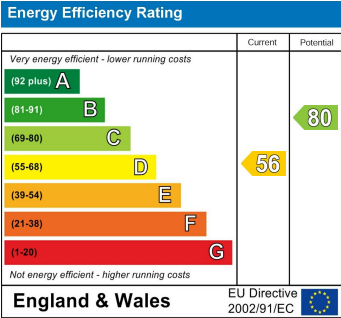

These particulars, whilst believed to be accurate are set out as a general outline only for guidance and do not constitute any part of an offer or contract. Intending purchasers should not rely on them as statements of representation of fact, but must satisfy themselves by inspection or otherwise as to their accuracy. No person in this firms employment has the authority to make or give any representation or warranty in respect of the property.